

OUTSIDE PANEL



INSIDE PANEL

SAFETY INSTRUCTIONS

- Do not use if chipped or cracked.
- Keep out of reach of children.
- Stovetop safe.
- Not suitable for microwave.
- Dishwasher safe.
- Caution is required when handling hot water.
- It is recommended to use a pot holder while pouring hot water in the teapot.

SÉCURITÉ D'ABORD!

- Ne pas utiliser si ébréchée ou fissurée.
- Tenir hors de la portée des enfants.
- Peut être utilisée sur la cuisinière.
- Ne convient pas dans le micro-ondes.
- Peut être mise au lave-vaisselle.
- La prudence est requise lors de la manipulation d'eau chaude.
- Il est recommandé d'utiliser un support à pot en versant de l'eau chaude dans la théière.

LOOSE LEAF TEA BREWING INSTRUCTIONS INSTRUCTIONS DE BRASSAGE DU THÉ EN VRAC



FLOWERING TEA BREWING INSTRUCTIONS INSTRUCTIONS DE BRASSAGE DES FLEURS DE THÉ

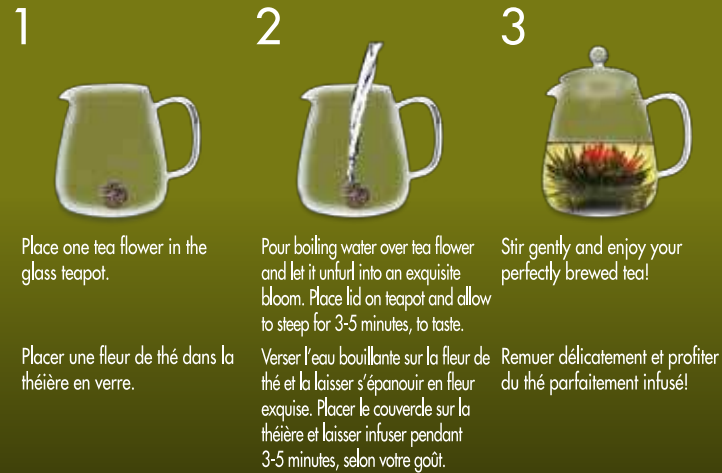

primula®

Thank you for purchasing the Primula® Layla glass teapot. We hope you enjoy the quality craftsmanship of this splendid glass teapot.
Merci d'avoir acheté la Théière Layla en verre Primula®. Nous espérons que vous apprécierez l'artisanat de haute qualité de cette théière en verre splendide.



Epoca®
INTERNATIONAL, INC.
Boca Raton, FL 33487
Made in China
Fabriqué en Chine

Epoca DT

851 Broken Sound Pkwy NW
#110, Boca Raton, FL 33487
561 353 3928

File

Date

Dieline N/A

UPC N/A

Colors 0000 0000
CMYK 0000 0000

Print Litho laminates

Corrugated TBD by the printer

Proof 100%

Signoff

KN	AK	PC
BP	BM	SM

Document Checklist for Designer

- Design Design Consistency with line
 Eng/Fre on appropriate panels
- Legal Stroke wt and rev. type printable
 ® and ™ symbols placed
 Copyright endorsement
 Company logo legible
 Domicile information
- Print UPC No., size, direction, color
 Artwork on printside of dieline
 Dieline number or dimensions
 Clearance from fold and cut
 Bleeds, ink coverage on inner flaps
 Glue, seal areas clear of colors
 Representation of overprint
 Separation match color proof
 Solid black areas with 40% cyan
 0.5pt Dieline overprint
 Registration colored Cropmarks
- Files Image file names properly
 Image resolution, mode, linked
 Any other image info

Instructions for Printer

Please make sure before going to press:

- Dieline size
- Image mode, resolution and size for printability
- Images are linked not embedded
- Correct the bleed if required
- Gradients printability
- Adjust dot gain, knockout, overprint and/or any other production considerations

PLEASE ALSO SUPPLY A JPEG PROOF OF THE RIPPED FILE BEFORE PLATE MAKING AND/OR PRINTING

Epoca will not be responsible for any work performed without prior permission and also if the process instructions not followed. This PDF file is not accurate for colorproofing and therefore it is the sole responsibility of the printer to match Pantone and CMYK standards.

THE PDF FILE IS FOR PREVIEW ONLY AND SHOULD NOT BE USED FOR FINAL REPRODUCTION.

Legend Diecut Perforation Scoreline